



Features

- ✦ Min/max Operating pressure 10 / 70 bar
- ✦ Large clamping range
- ✦ Cylinder swing direction available clockwise (RH) & counter clockwise (LH)
- ✦ Double action range
- ✦ 360° adjustable arm location
- ✦ Arm swing will be $90^{\circ} \pm 1^{\circ}$

✦ Outline Dimension

✦ Machining Dimension

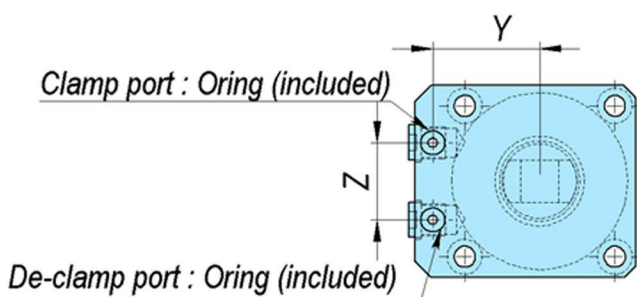
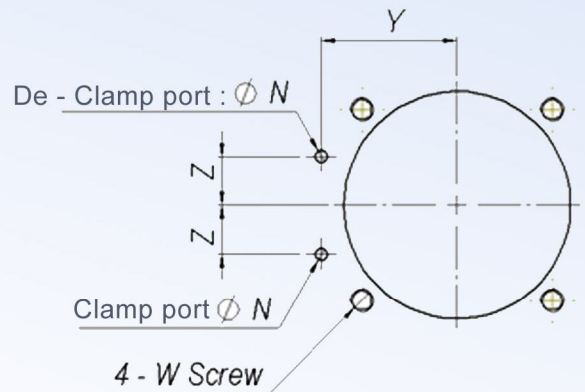
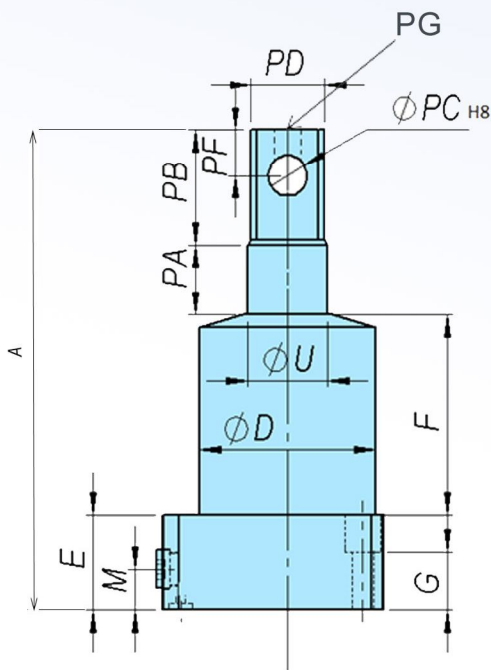
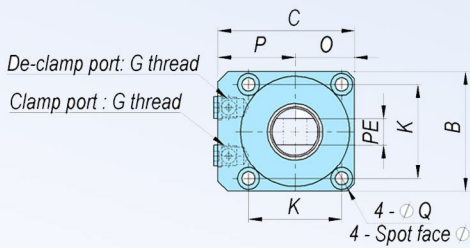

KNOW HOW TO ORDER



- 1** Bottom mounting
- 2** Body Size
- 3** Type
- 4** Piping Method (M=Manifold type, P=Piping type)
- 5** Swing direction (L=Left, R=Right)
- 6** Angle for swing

Dimension Table

Model No.	HSB0481 M L P R 90	HSB0551 M L P R 90	HSB0651 M L P R 90	HSB0751 M L P R 90	HSB0901 M L P R 90	HSB1051 M L P R 90
A	121	136	145	171.5	185	234.5
B	52	60	70	80	95	120
C	61	69	81	92	107	127
ØD	Ø48	Ø55	Ø65	Ø75	Ø90	Ø105
E	28	28	30	37	40	50
F	52	59	63	71	74	99
G	18.5	17	18	22	22	24.5
K	40	47	55	63	75	88
M	11	11	12	12	16	17
N	3	3	3	3	3	4
O	26	30	35	40	47.5	60
P	35	39	46	52	59.5	67
Q	5.5	6.6	6.6	9	11	14
R	9.5	11	11	14.5	17.5	20
U	22	25	30	36	45	55
Y	30	33.5	39.5	45	52.5	60
Z	22	24	30	32	37	45
PA	16	18.5	20	23.5	25	30.5
PB	25	30.5	32	40	46	55
ØPC	8	10	12	12	16	20
ØPD	20	23	28	34	43	53
PE	23.5	29	30.5	38.5	44.5	53.5
PF	10	12	15	16.5	20	24
PG	M4	M5	M6	M6	M8	M8
Clamp Port/	M- option	G1/8	G1/8	G1/4	G1/4	G1/4
De-clamp Port	P- option	G1/8	G1/8	G1/4	G1/4	G1/4
O-Ring	1BP5	1BP5	1BP7	1BP7	1BP7	1BP7
Bore	Ø36	Ø44	Ø50	Ø63	Ø72	Ø80

Specification Table

Model No.	HSB0481 M L P R 90	HSB0551 M L P R 90	HSB0651 M L P R 90	HSB0751 M L P R 90	HSB0901 M L P R 90	HSB1051 M L P R 90
CLAMPING FORCE (kN)	4.7	6.9	9	13.7	20	28
FULL STROKE	15.5	18.5	20	24	26	32
SWING STROKE (90°)	7.5	8.5	10	12	14	16
VERTICAL /LOCKING STROKE	8	10	10	12	12	16
Cyl. Volume Locking cm ³	7	13.2	25.2	42.3	102.6	151
Cyl. Volume Release cm ³	12.5	20.9	37.1	68.7	127.8	199.5
Max. operating pressure (MPa)	7					
Min operating pressure (MPa)	1.5					
Design pressure (Mpa)	10.5					
Temperatur °C	0-70					
Weight kg	1.3	1.8	2.7	4.2	5.5	9

Machining dimension table for mounting :

Model No.	HSB0481 M L P R 90	HSB0551 M L P R 90	HSB0651 M L P R 90	HSB0751 M L P R 90	HSB0901 M L P R 90	HSB1051 M L P R 90
Z	22	24	30	32	37	45
W (Nominal x pitch)	M 5 X 0.8	M 6 X 1	M 6 X 1	M 8 X 1.25	M 10 X 1.5	M 12 X 1.75
N	Ø3	Ø3	Ø5	Ø5	Ø5	Ø5
K	40	47	55	63	75	88
Y	30	33.5	39.5	45	52.5	60